

① Peter  
② **FILE**

25 August 1998

Please Quote: P17066

Doc No: 96625

Canmap Consultants  
PO Box 396  
ROTORUA

Attention: Fergus Cumming

Dear Sir,

**CONSULTATION - RURAL SUBDIVISION**

Thank you for your letter of 21 August 1998 regarding a proposed rural subdivision located at Te Weta Road. The matter was raised with the Consultation Committee and we advise that the contact people for this area are Rawiri Te Whare, Waiairiki Polytechnic – Ph: 3468-999; and Timoti Rangitakatu of Ngati Tahu Runanga, PO Box 162, Reporoa.

Thank you for your early advice.

Yours sincerely



Stephen Colson  
Manager Planning Services



1180 Amohia Street  
P O Box 396  
Rotorua

Phone 07 347 9482  
Fax 07 347 6652  
email: canmap@xtra.co.nz

Date: 21 August, 1998

Pages: 2  
(including this one)

To: Rotorua District Council

From: Fergus Cumming

Attention: Director of Environmental Services

Our Ref: 4869.3481

Fax No: 350 0184

**RE: RURAL SUBDIVISION - CONSULTATION**

---

We have been instructed to proceed with the subdivision of Sections 43, 44, 45 and 47 Block V Ngongotaha. The subdivision is, at this stage, going to produce three general rural lots and may also provide one or more lifestyle allotments. A copy of the relevant planning map is following.

There are no sites of cultural significance indicated on the Planning Maps or in Appendix A of the Proposed District Plan in relation to the subject property.

Please advise whether Council require further consultation with iwi beyond that undertaken by Rotorua District Council during the preparation of the Plan, and if so, with whom do staff wish the applicant to consult.

The proposal is not developed in any form at this stage.

Should you require further information to determine the consultation requirement, please do not hesitate to ask.

Regards,

**FERGUS CUMMING**

**CONFIDENTIALITY:** The information contained in this facsimile (including attachments) is confidential information and may also be legally privileged, intended only for the use of the individual and entity named above. If you are not the intended recipient, you are hereby notified that any use, review dissemination, distribution or copying of this document is strictly prohibited. If you have received this document in error, please immediately notify us by telephone. Please call collect to the person and number above and destroy the original message. Thank you.

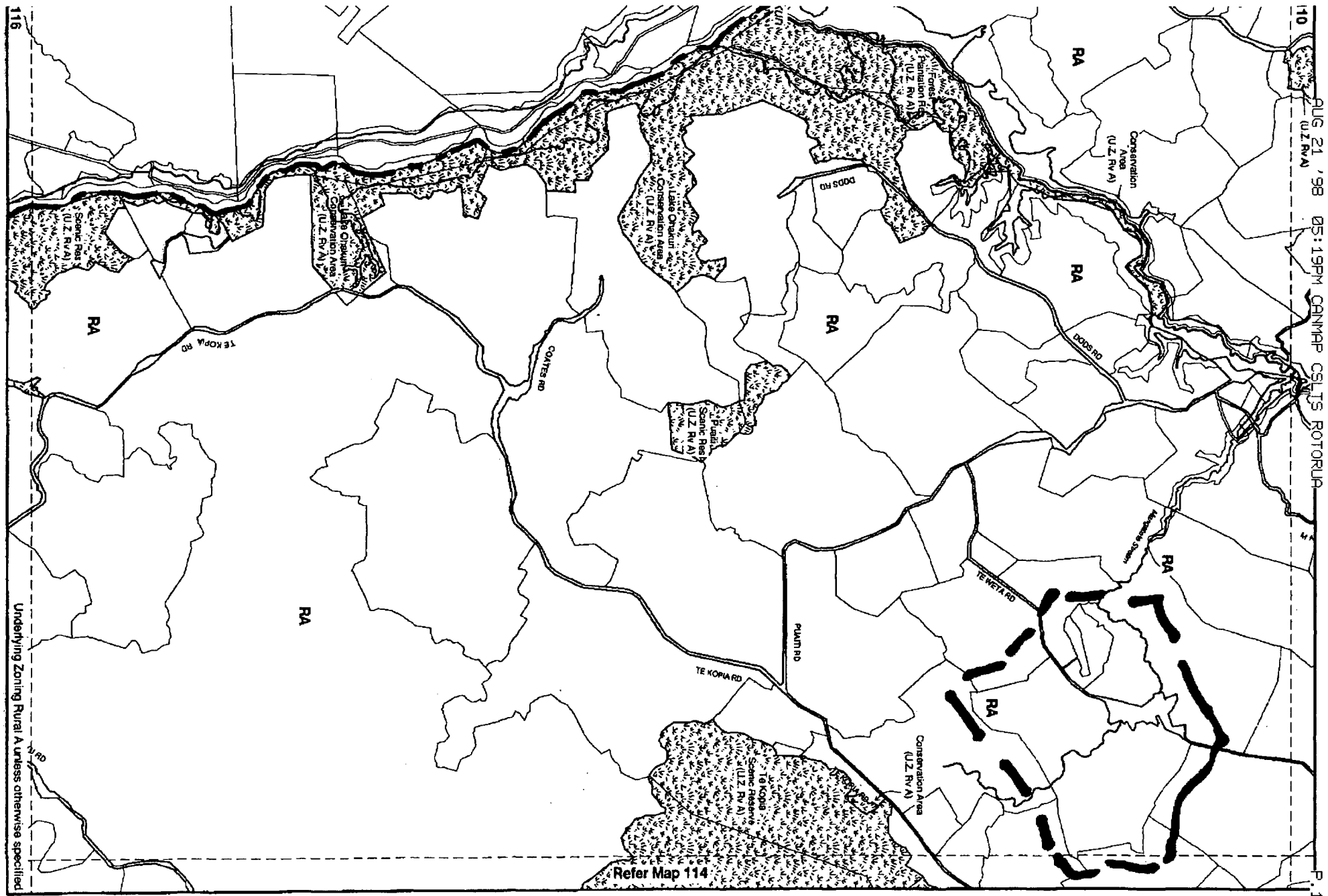

# Proposed Rotorua District Planning Map

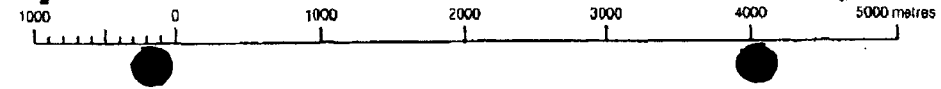



RM01

Doc.No: 92282v2

File Ref: .....

Your Ref:.....

Date:.....

Martin McCaulay Morton

Surveyors

Phipps Hawley

Private Bag RO 3029  
Rotorua  
New Zealand  
Telephone 07-348 4199  
Fax 07-346 3143

Address all  
communications to:  
District Manager  
Rotorua District Council

Attn: .....

Dear Sir/Madam,

**APPLICATION FOR RESOURCE CONSENT -**

(Owner or Applicant)

(Address)

(Locality)

Your application for resource consent has been considered by the Council's consultation committee. Consultation with particular members of the Maori community is considered necessary in respect of your application, to ensure compliance with the Resource Management Act 1991.

You are advised to contact

*Raniri Te Nhave, Hainiriki Polytech PH 3468999*  
(Name of contact and address)

*P.O. Box 162  
Reporoa*

The purpose of your consultation will be to ascertain whether there are any features of cultural significance located within your land such as an archaeological site, waahi tapu or urupa (burial site).

The request for this information is made under Sections 92(1) and 92(2)(a)(ii) of the Resource Management Act 1991 and is to fulfil Council's obligations under Sections 6(e) and 8 of the Resource Management Act 1991. In the meantime, your application has been placed on hold although staff will process the application as far as possible.

Should you have difficulty in making the necessary contact, or in obtaining a response, please contact the writer.

Yours faithfully

Planner



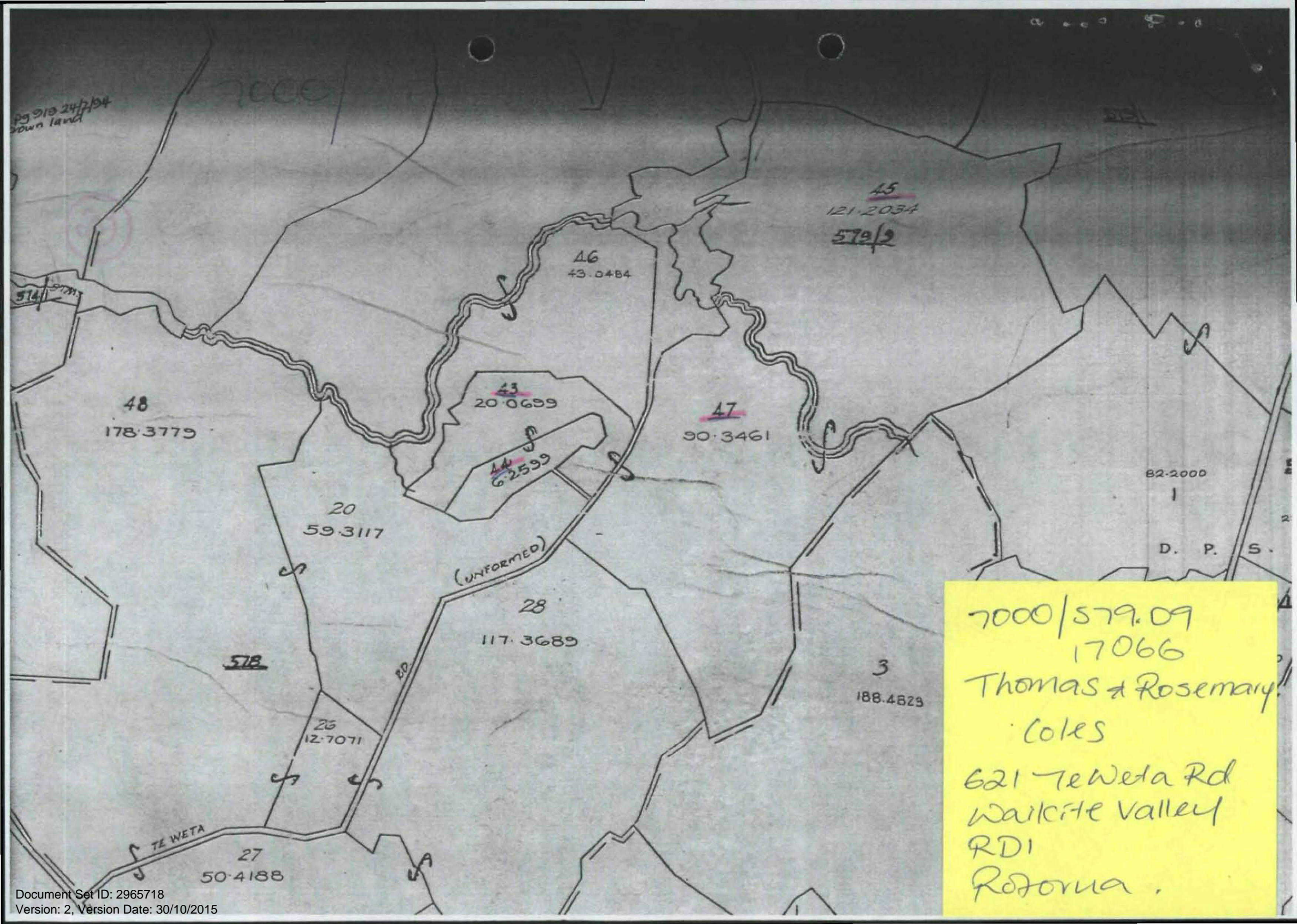

7000/579.09  
17066  
Thomas & Rosemary  
Coles  
621 Te Weta Rd  
Waikite Valley  
RDI  
Rotorua.